

Buffer storage / Thermal insulation

500 litres, 5 and 10 spigots ↗ 750 litres, 5 and 10 spigots

1000 litres, 5 and 10 spigots ↗ 1500 litres, 5 and 10 spigots

↗ Buffer storage; 5 spigots

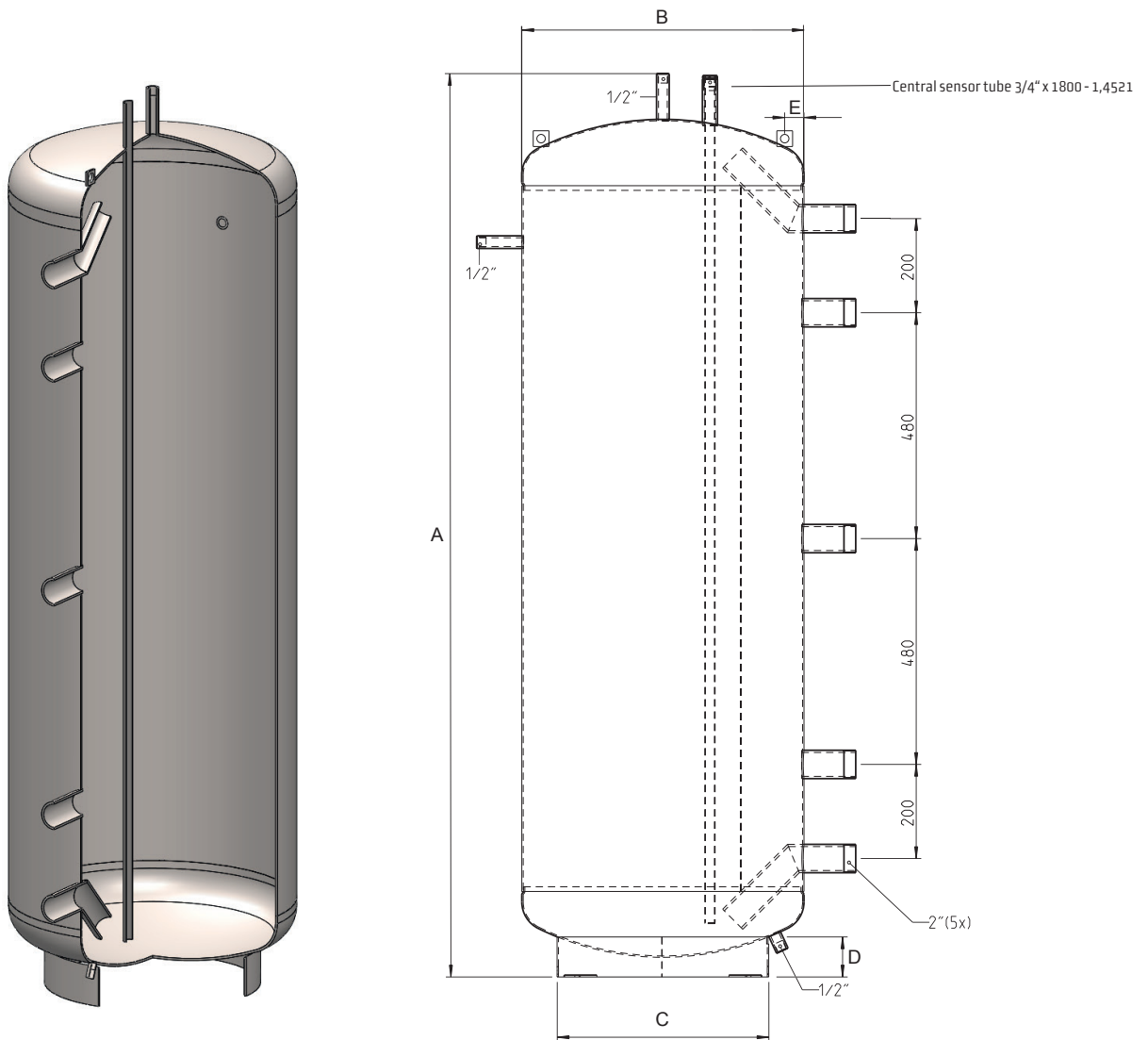

Buffer storage; 5 spigots

Litres	A	B	C	D	E	Tilted dimension	Article no.
500	1.920 mm	600 mm	450 mm	85 mm	41 mm	1945 mm	102 182 0
750	1.998 mm	750 mm	600 mm	103 mm	41 mm	2037 mm	102 182 1
1.000	2.005 mm	850 mm	640 mm	106 mm	75 mm	2050 mm	102 182 2
1.500	2.094 mm	1.000 mm	850 mm	124 mm	100 mm	2162 mm	102 182 3

↗ Buffer storage; 10 spigots

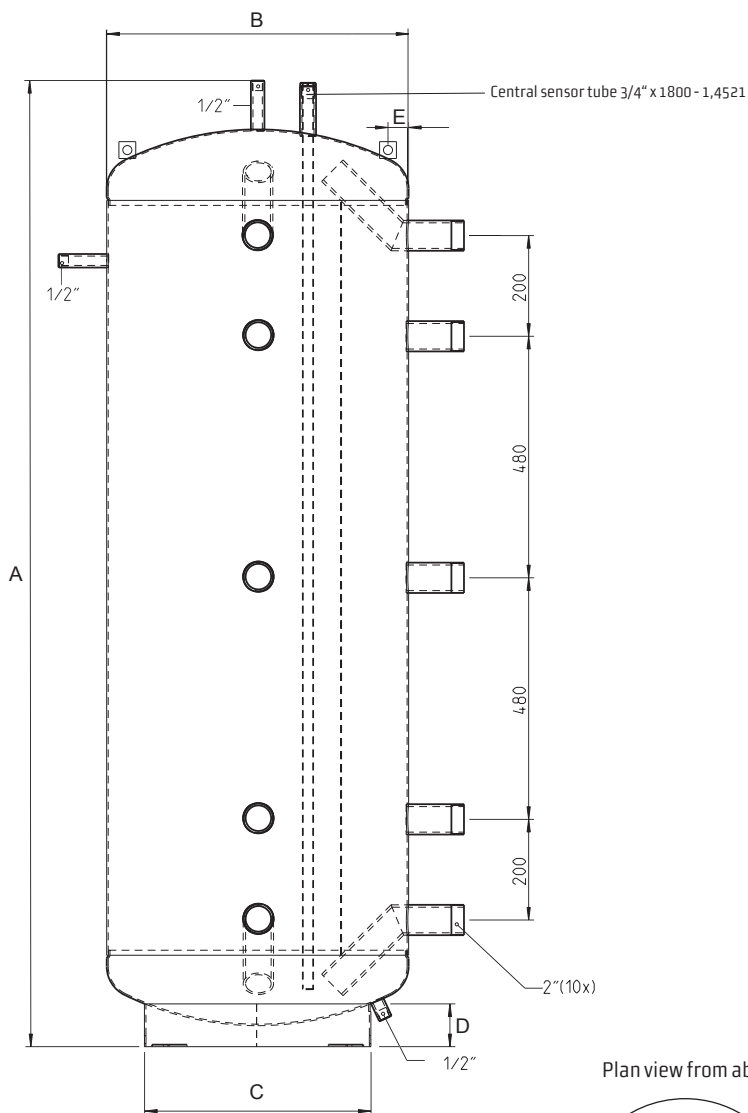
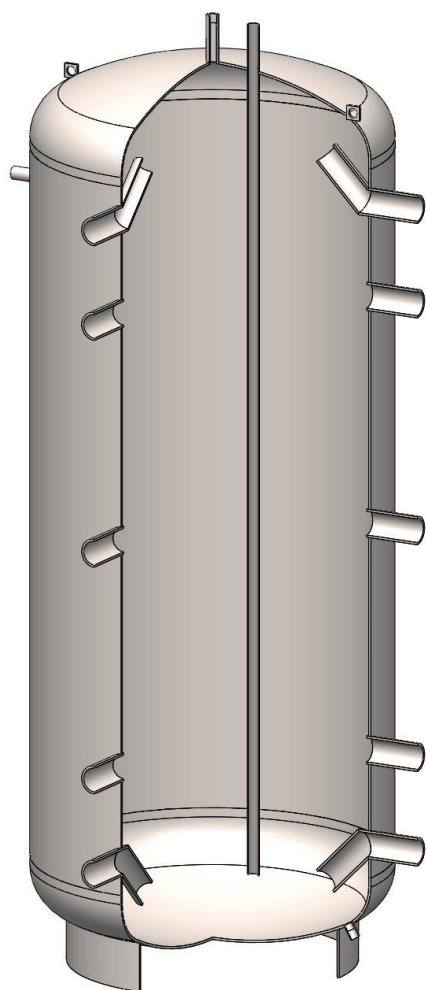

Plan view from above

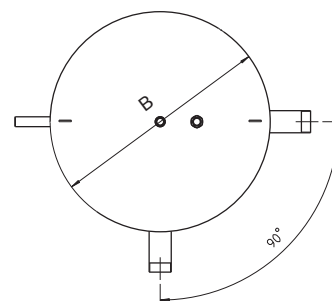

Buffer storage; 10 spigots

Litres	A	B	C	D	E	Tilted dimension	Article no.
500	1.920 mm	600 mm	450 mm	85 mm	41 mm	1945 mm	102 182 4
750	1.998 mm	750 mm	600 mm	103 mm	41 mm	2037 mm	102 182 5
1.000	2.005 mm	850 mm	640 mm	106 mm	75 mm	2050 mm	102 182 6
1.500	2.094 mm	1.000 mm	850 mm	124 mm	100 mm	2162 mm	102 182 7

➤ Technical description

Buffer storage

Wide range of applications, available in threaded or flange connection. Upright cylindrical design with dished ends and a foot ring. The 10-spigot design is ideal for the additional optional integration of renewable energies. Built to factory standard, according to DIN 4753 Part 3, and regulations governing pressurised containers for heating systems according to DIN 4751. Manufactured from ST37-2 grade steel according to DIN 17100, untreated inner, outer primed with a rust-proof coating.

In the 10-spigot design, every 5th spigot is offset laterally at 90°. In addition, there are three 1/2" sleeves to allow for ventilation or emptying, or for individual use (thermometer). To ensure maximum buffer loading efficiency, the buffer contains a central sensor tube for optimal placement (up to 4 sensors). On request, during factory production an optional hand hole can be welded to accommodate storage heat exchangers and delivered.

➤ Output data

Thermal insulation for buffer storage

Rigid foam thermal insulation for optimal prevention of heat loss.

- Consists of**
- › 75 mm all-round rigid foam (comprising 2 half shells)
 - › 90 mm rigid foam insulation on top
 - › Plastic cover on top, round, black
 - › With DN50 spigots (2" external threads)
 - › Incl. 1 central sensor tube $\varnothing 20 \times 1.5$ mm made from 1.4521 stainless steel

- Heating**
- › Permissible operating pressure: 3 bar (6 bar possible on request)